



Air Test Gauge Assembly

SPECIFICATION SHEET



- Quality bourdon tube gauge
- 2" steel case w/shatter proof lens
- Schrader inlet valve supplied
- 3/4" female iron pipe thread air block on assemblies

Part No.	Description
GT-34-15-H	2" Face, 0-15 PSI, Gauge Assembly
GT-34-30-H	2" Face, 0-30 PSI, Gauge Assembly
GT-34-60-H	2" Face, 0-60 PSI, Gauge Assembly
GT-34-100-H	2" Face, 0-100 PSI, Gauge Assembly
GT-34-160-H	2" Face, 0-160 PSI, Gauge Assembly
GT-34-200-H	2" Face, 0-200 PSI, Gauge Assembly

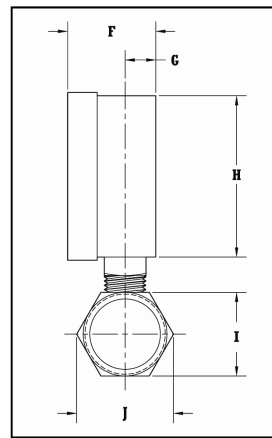
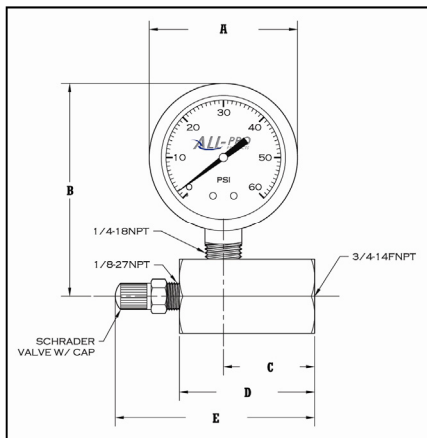

A	B	C	D	E	F	G	H	I	J
2.20"	3.16"	1.35"	2.00"	2.95"	1.15"	0.40"	2.11"	1.10" Hex Flats	1.26" Hex Points



Alliance Manufacturer Representatives
 1812 Durham
 P.O. Box 701085
 Houston, Texas 77270
 (800) 324-9400 / (281) 579-9400
 Fax: (800) 483-6695 / (281) 579-9849
www.alliancereps.com

Alliance Manufacturer Representatives, inc. reserves the right to change materials or modify the Design or specifications of its products without notification as part of the company's continuing Product improvement program.

© Copyright Alliance Mfg. Representatives, Inc. 2007. All Rights Reserved. (11-07)

Job Name	Date
Part Number	Qty
Contractor	
Architect	